

Standard package

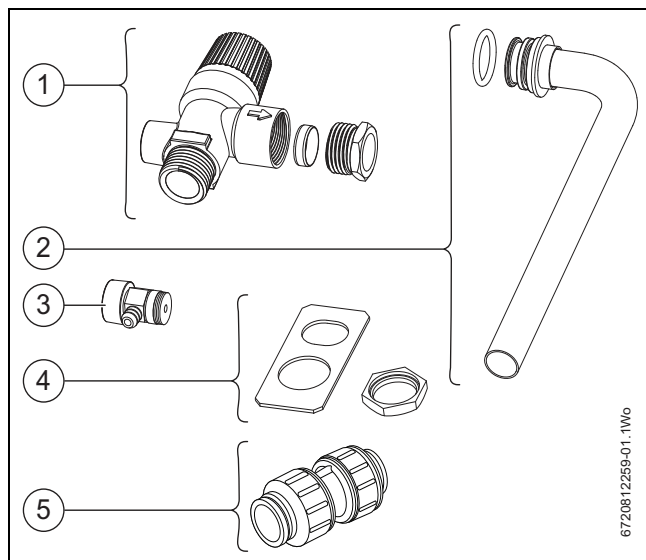

Fig. 1 Standard package

- [1] 3 bar pressure relief valve with G $\frac{1}{2}$ thread and 15mm compression
- [2] 15mm adaptor pipe and connection fitting "O" ring
- [3] Manual air vent
- [4] Support bracket and lock nut
- [5] Push fit connector

General Overview

**CAUTION:** Risk from blockages

Frozen or restricted system water in the remote pressure relief valve and connecting pipework preventing discharge if pressure exceeds 3 bar.

- Remote pressure relief valve and connecting pipework must be installed in heated areas only to prevent the possibility of freezing.
- Do not install valves in the remote pressure relief valve connecting pipework.

**NOTICE:** Adaptor pipe connection

- The adaptor pipe 15mm connection to connecting pipework must be a breakable joint using the push fit connector supplied.

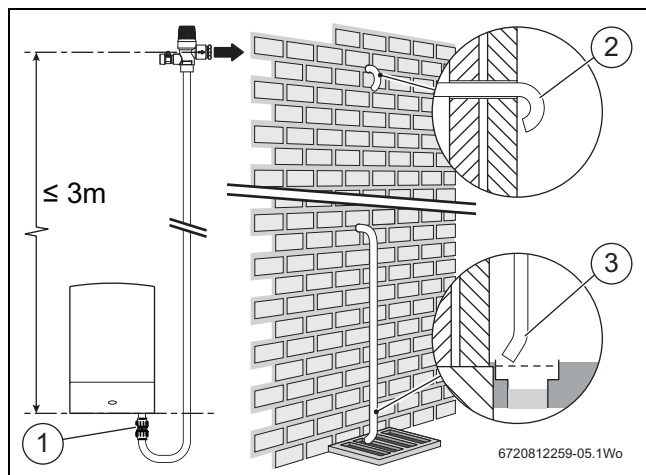

Fig. 2 Example layout

- [1] Push fit connection
- [2] Outlet facing external wall
- [3] Outlet to external drain

Total length of pipe must not exceed 3 metres in length.

**NOTICE:** Ensure no stress on pipework or appliance hydraulic block.

Damage to pipework or appliance hydraulic block.

- The remote pressure relief valve and connecting pipe work must be adequately supported in accordance to the industry best practice standards.

**Before hanging the appliance:**

- The appliance pressure relief valve must be removed.
- The adaptor pipe must be fitted in place of appliance pressure relief valve.
- The following steps describe the necessary steps.

Appliance pressure relief valve replacement with adaptor pipe (This must be carried out before the appliance is installed onto the wall frame)

- Release the spring clip [2] from the pressure relief valve housing.
- Withdraw the pressure relief valve [1] from its housing.

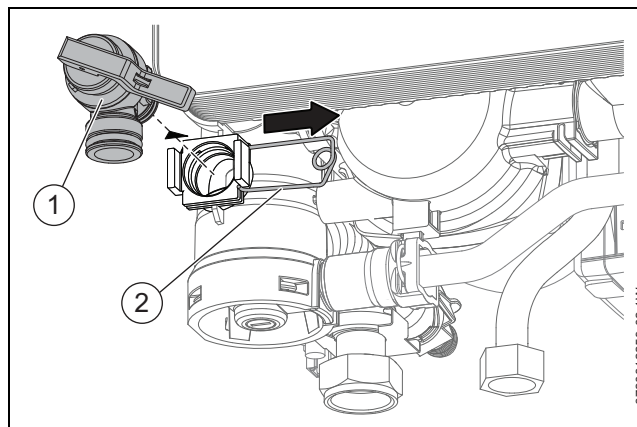

Fig. 3 Appliance pressure relief valve removal

- Fit the "O" ring onto the 15mm adaptor pipe figure 1, item [2] and insert into the pressure relief valve housing.
- Secure the pipe connection in position with the spring clip [2]. With the pipe connection in place, lift the appliance onto the wall frame.

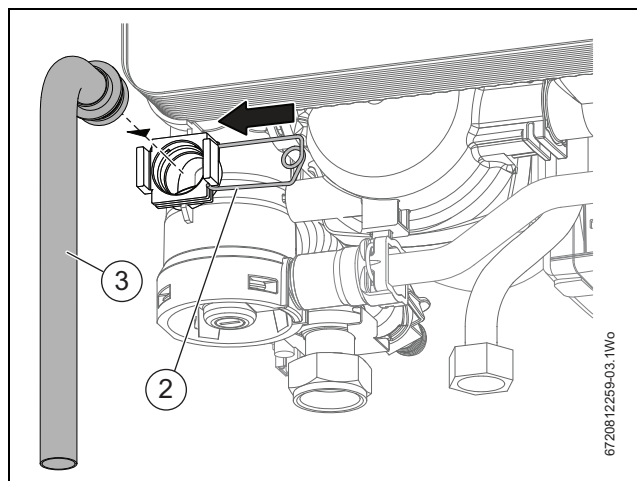

Fig. 4 Fitting pipe connection

Support bracket installation

The support bracket ensures the adaptor pipe exiting the appliance hydraulic is vertical and allows easier installation to the connecting pipework.

Before installing the connecting pipework.

- ▶ Fitting the support bracket [3] to the right hand side of the connections manifold,
 - Slide the support bracket slotted hole up the pipe [1] and align the other hole with the original threaded pressure relief valve outlet [2].
- ▶ Secure the support bracket in place with the lock nut [4].
- ▶ Fit the push fit connection [5], from there the connecting pipework can be installed.

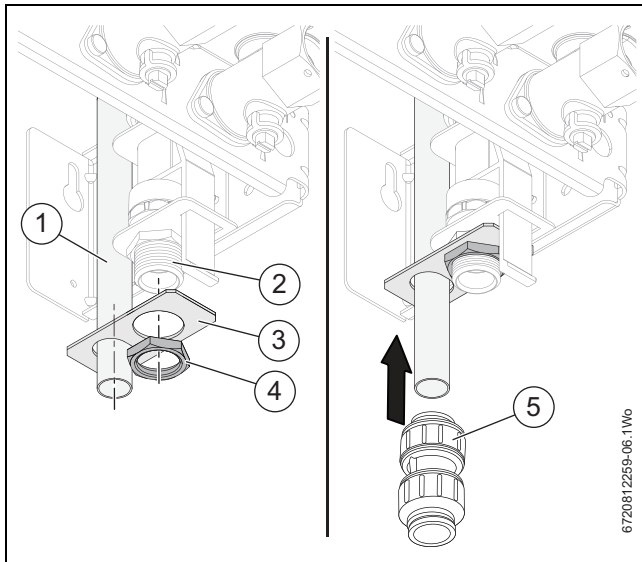

Fig. 5 Fitting support bracket

Remote PRV connection

- ▶ Connect the manual air vent [2] to the pressure relief valve [1].
- ▶ Once the 15mm connecting pipework has been fitted, connect it to the G $\frac{1}{2}$ threaded fitting [3] with the appropriate fixing (not supplied).
- ▶ Connect the relief discharge to drain pipework [4], to the pressure relief valve [1].
 - The connection is an 15mm compression fitting.

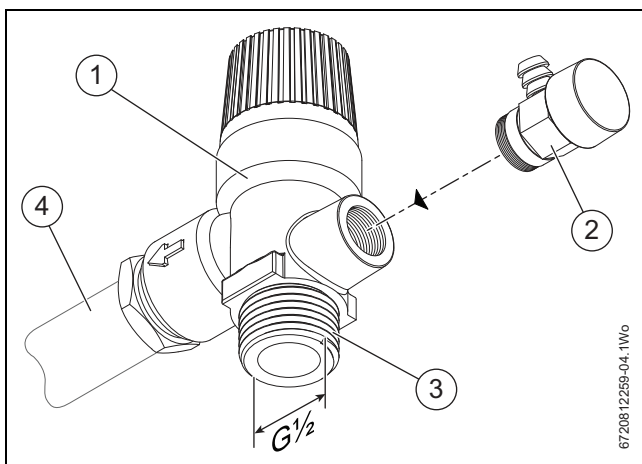

Fig. 6 Remote pressure relief valve connection

- [1] Remote pressure relief valve.
- [2] Manual air vent.
- [3] System water connection up to 3bar (G $\frac{1}{2}$ threaded).
- [4] Relief discharge to drain (15mm compression fitting).